

GET IN THE FLOW

CHOOSE THE LIQUID HANDLING ROBOT, FLOWBOT ONE, FOR A MORE FLEXIBLE AND RELIABLE SOLUTION

THE NEXT GENERATION OF LIQUID HANDLING ROBOTS

- Easy to use for scientist – no programming needed
- 12 positions at deck – flexible and future proven, reliable results, safety and increased productivity
- No IT installation required. The software runs in your web browser via an enclosed WIFI system
- Setup of pipetting programs takes only minutes with the “drag and drop” function
- Computer vision technology (QR) recognizes you components – improves user safety and quality
- Precision and accuracy complies with the ISO 8655 standard



| Designation | Part no. |
|--|-------------------|
| FLOWBOT ONE | 041-413055 |
| FLOWBOT ONE with UV lamp | 041-413056 |
| FLOWBOT ONE with UV lamp and HEPA filter | 041-413057 |

LABWARE

Standard components already predefined in the software. New components can easily be defined by the user

PIPETTE TIPS USAGE

Automatic calculation of number of pipette tips needed for each run. If needed new time estimation for new loading is provided.

TIP DETECTION

Pipette modules automatically detect if tips are on or not

LIQUID LEVEL DETECTION

Pipette modules automatically detect the liquid level

MORE FEATURES

- Bottom touch
- Optional tip reuse
- Pause (reaction or incubation time)
- Customizable liquid classes
- CSV Import/Export of programs
- Logs of executed programs
- Sharing programs between users
- A time estimation for the length of the program is made for each run

Learn to use it in 1 hour
- and make programs in minutes!

SOME KEY FEATURES:

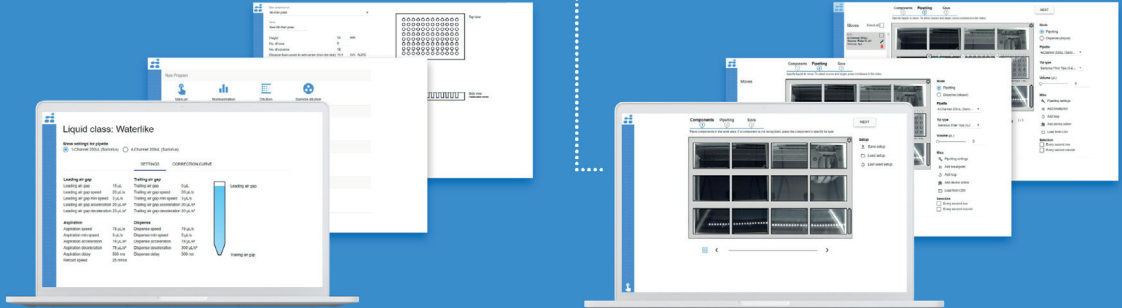

- Open API for easy integration
- Log files - both PDF and CSV
- Barcode scanning for data transparency
- Previews programs before run
- Create your own liquid classes and components
- Compatible with various devices

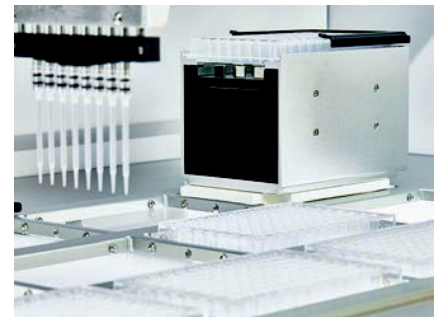
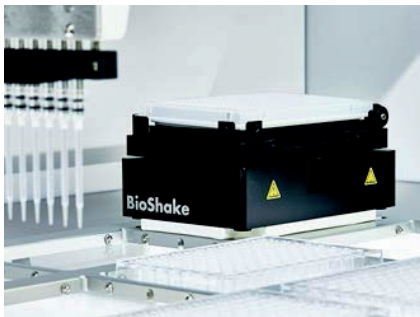

| Part no. | Designation |
|------------|---|
| 041-413020 | Bioshake 3000 |
| 041-413021 | Coldplate |
| 041-413022 | BioShake 3000-T |
| 041-413024 | Magnetic Module |
| 041-413023 | Handheld bar-code scanner |
| 041-413186 | ScanID, a semi automated and flowbot ONE integrated barcode scanner - ScanID, power supply, ethernet and USB adapter cables 3 LineRacks, 1 Tube Deck and SLAS Adapter |

| Part no. | Designation |
|------------|---|
| 041-413043 | Flow Robotics Filter Tips - 200 µL. Filter tip - 2.304 TIPS (24 X 96 TIPS/BOX) |
| 041-413044 | Flow Robotics Filter Tips - 50 µL. Filter tip - 2.304 TIPS (24 X 96 TIPS/BOX) |
| 041-413045 | Flow Robotics Filter Tips - 1000 µL. Filter tip - 1.536 TIPS (16 X 96 TIPS/BOX) |
| 041-413046 | Tipbox Adapter - FLOW ROBOTICS FILTER TIPS 50UL |
| 041-413047 | Tipbox Adapter - FLOW ROBOTICS FILTER TIPS 200µL |
| 041-413048 | Tipbox Adapter - FLOW ROBOTICS FILTER TIPS 1000µL |



Various devices are already integrated in the software and can be placed on any of the 12 positions on the deck.

MANY OTHER OPTIONS ARE AVAILABLE , CONTACT US FOR MORE INFORMATION AND DEMONSTRATION ON FLOWBOT

OUR SERVICE TECHNICIANS ARE OFFICIALLY TRAINED FOR MAINTENANCE

